

HOUSING FOR STRAIGHT PLUG

**R197.112.Z90**

**ORIGINAL**

Series : SMB  
CARLOCK

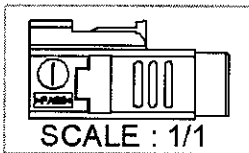
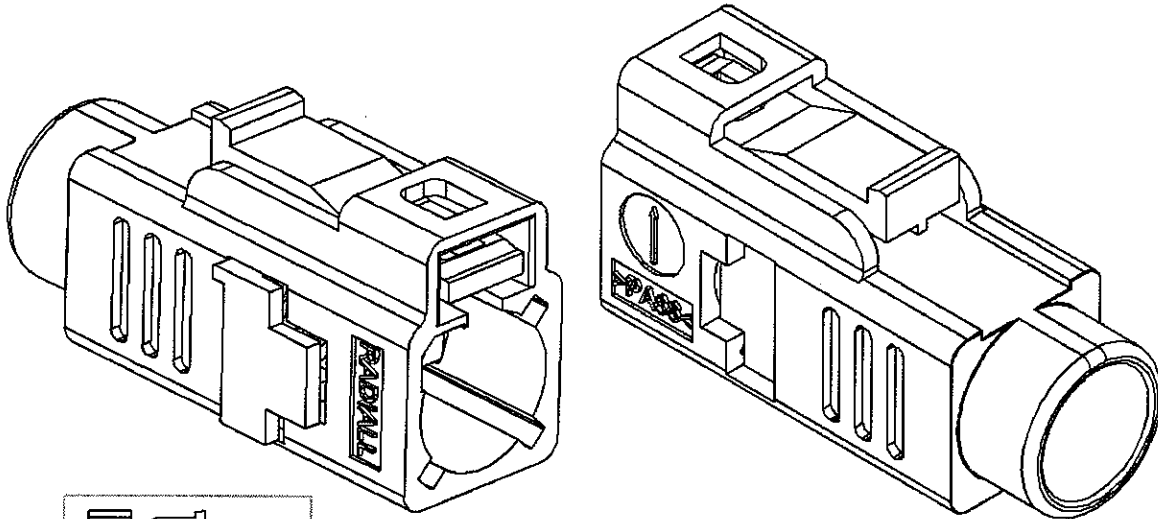
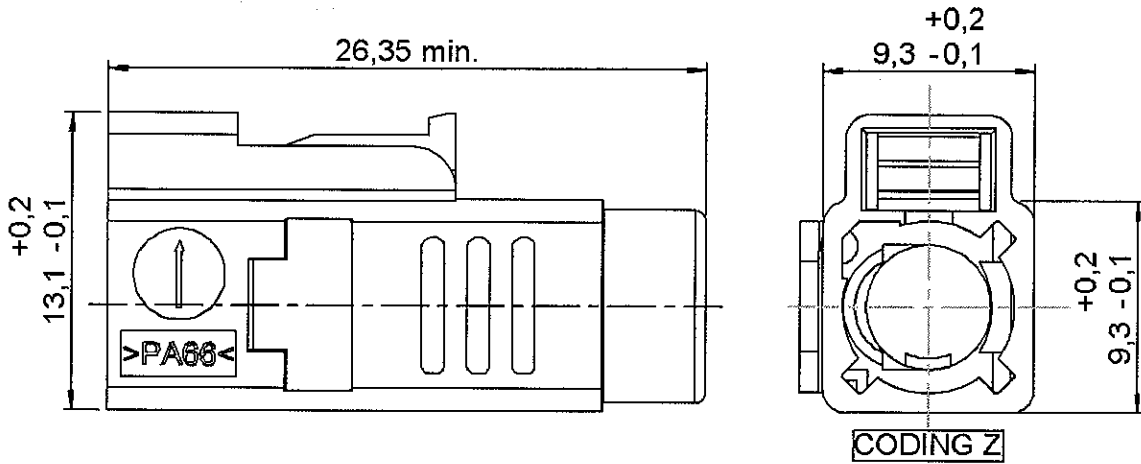

All dimensions are in mm.

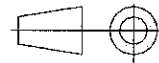

COMPONENTS		MATERIALS	PLATINGS (µm)	
HOUSING	PA66		UL CLASSIFICATION	COLOR
SECONDARY LOCK	PA66		UL 94 V-2	Water blue Ral5021
			UL 94 V-2	PURPLE Ral 4006
*According to FAKRA specifications				

Issue : 0741 B

In the effort to improve our products, we reserve the right to make changes judged to be necessary.



**HOUSING FOR STRAIGHT PLUG**

**R197.112.Z90**

Series : SMB  
**CARLOCK**

**ORIGINAL**

**PACKAGING**

Standard	Unit	Other
100	'W' option	Contact us

**SPECIFICATION**

QS9000

**ELECTRICAL CHARACTERISTICS**

Impedance		Ω
Frequency		GHz
VSWR	+ 0,0000	x F(GHz) Maxi
Insertion loss		√F(GHz) dB Maxi
RF leakage	- (	- F(GHz)) dB Maxi
Voltage rating		Veff Maxi
Dielectric withstanding voltage		Veff mini
Insulation resistance		MΩ mini

**ENVIRONMENTAL**

Operating temperature	-40/+110 °C
Hermetic seal	Atm.cm3/s
Panel leakage	

**OTHERS CHARACTERISTICS**

Assembly instruction **Page 3 & 4**

Others :

**HOUSING FOR COAX**  
 R114.082.325,R114.086.325,R114.089.325

**MECHANICAL CHARACTERISTICS**

Center contact retention		
Axial force – Mating end		N mini
Axial force – Opposite end		N mini
Torque		N.cm mini
Recommended torque		
Mating		N.cm
Panel nut		N.cm
Mating life	100	Cycles mini
Weight	1,3420	g

Issue : 0741 B

In the effort to improve our products, we reserve the right to make changes judged to be necessary.



**RADIALL**®

HOUSING FOR STRAIGHT PLUG

**R197.112.Z90**

Series : SMB  
CARLOCK

ORIGINAL

**RECOMMENDED MOUNTING PROCEDURE**

1

• Push the coax until it stops at the bottom of the housing

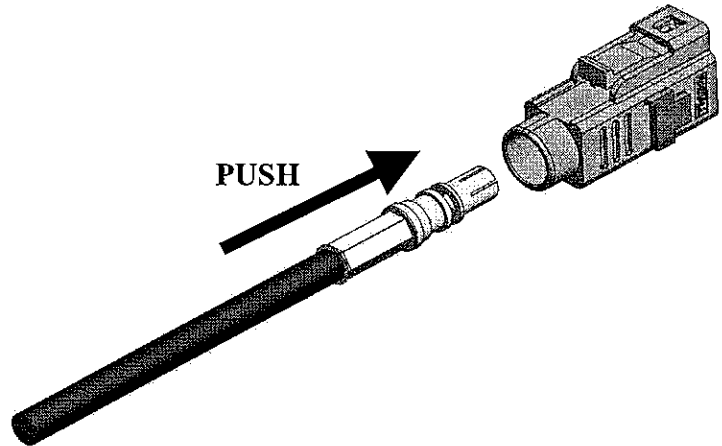

2

• Push the secondary lock in final position to secure the coax inside the housing (until it click on)

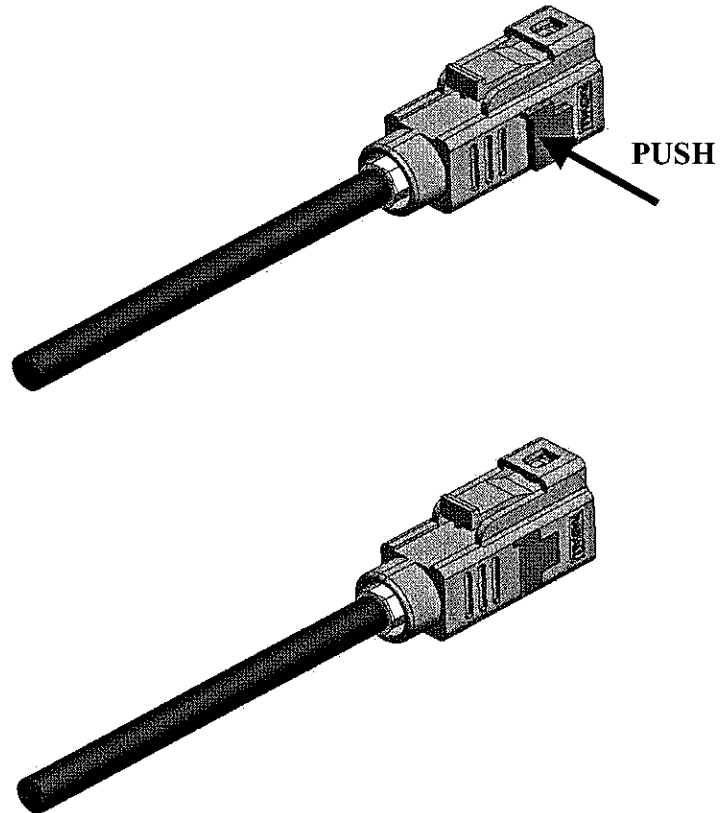

Issue : 0741 B

In the effort to improve our products, we reserve the right to make changes judged to be necessary.



## HOUSING FOR STRAIGHT PLUG

R197.112.Z90

Series : SMB  
CARLOCK

ORIGINAL

**RECOMMENDED DISASSEMBLING PROCEDURE**

1

- To unlock the coax from the CPA devise, push the secondary lock from the material marking side until it click on

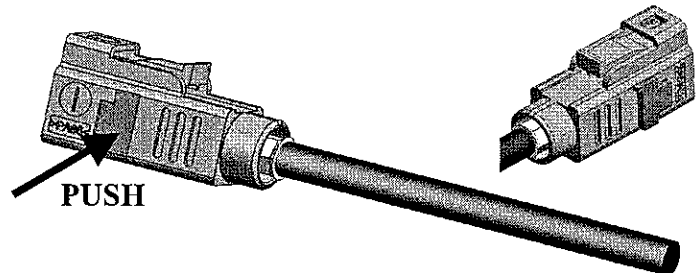

2

- insert a screw driver between the elastic finger and the slot of the housing as shown on the picture.
- Tip up the screw driver as shown on the picture to lift up the elastic finger and when it is done pull on the cable assembly to remove the coax from the housing.

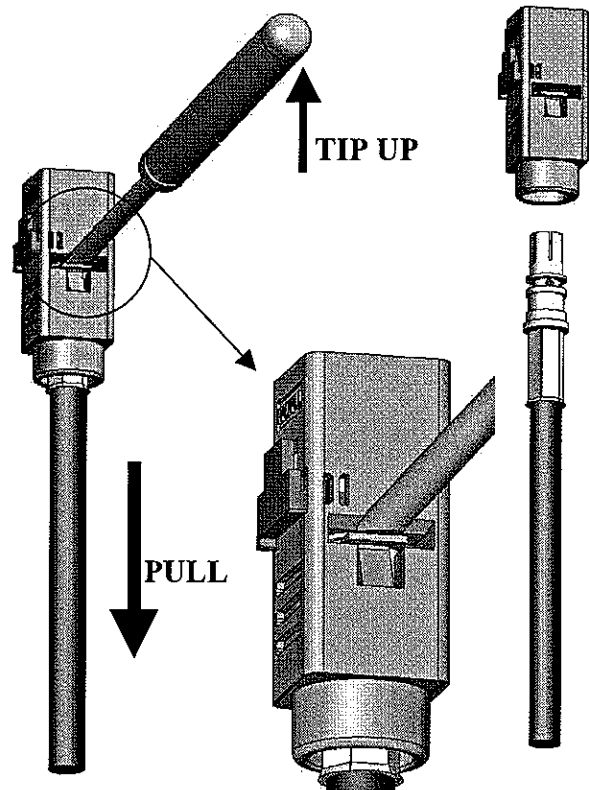

Issue : 0741 B

In the effort to improve our products, we reserve the right to make changes judged to be necessary.

**RADIALL**®